

REV  
C

REV

24852-RD-JD-J07-J0022

DWG. NO.

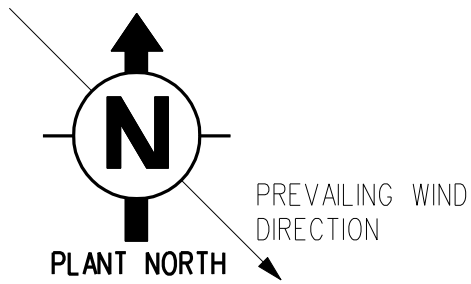

PREVAILING WIND  
DIRECTION

PLANT NORTH

CAMERA NUMBER / TAG TRANSLATION TABLE			
NO.	TAG NUMBER		
Y01	EE-J07	-XT	3001---
Y02	EE-J07	-XT	3002---
Y03	EE-J07	-XT	3003---
Y04	EE-J07	-XT	3004---
Y05	EE-J07	-XT	3005---
Y06	EE-J07	-XT	3006---
Y07	EE-J07	-XT	3007---
Y08	EE-J07	-XT	3008---
Y09	EE-J07	-XT	3009---
Y10	EE-J07	-XT	3010---
Y11	EE-J07	-XT	3011---
Y12	EE-J07	-XT	3012---
Y13	EE-J07	-XT	3013---
Y14	EE-J07	-XT	3014---

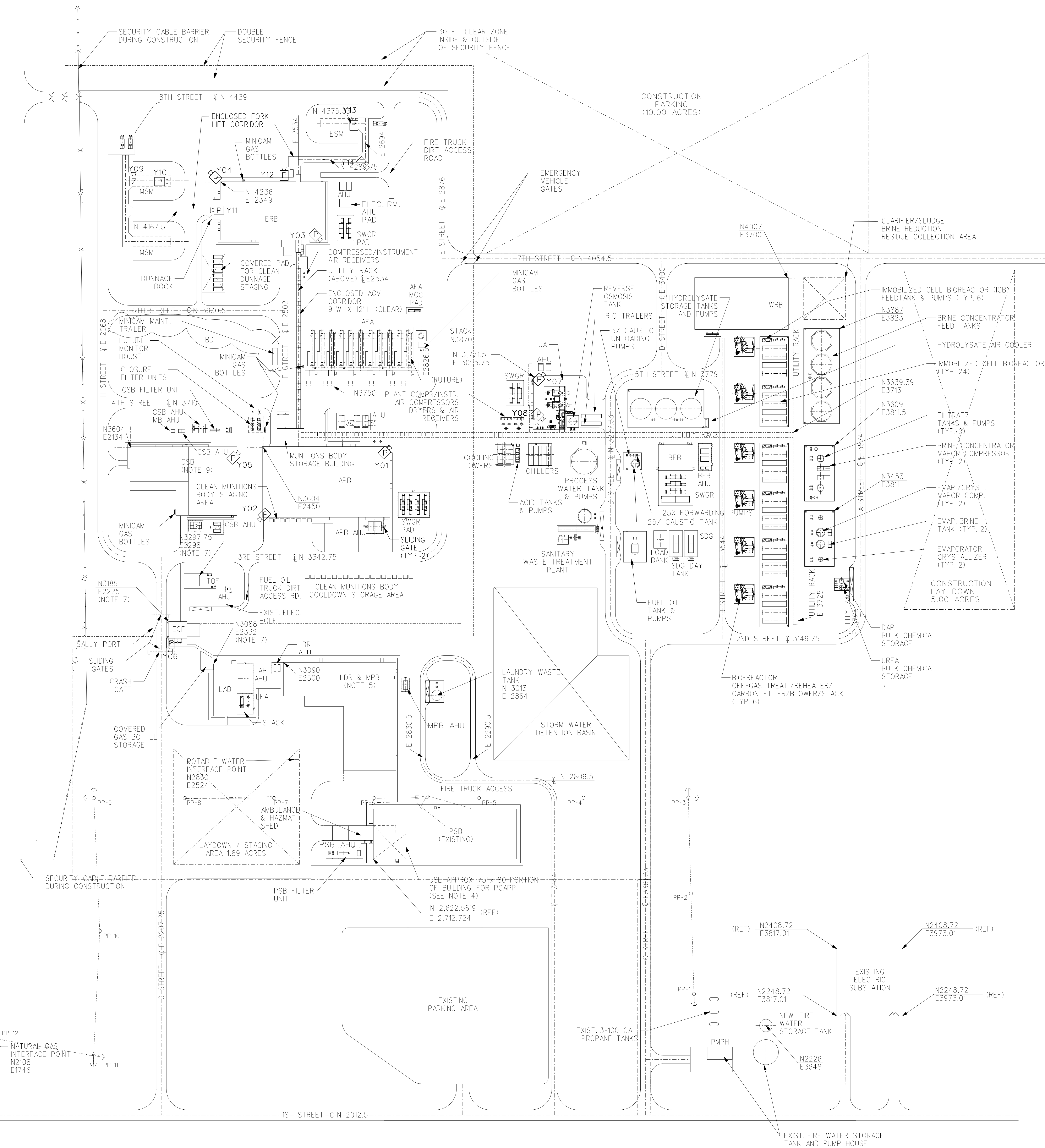

GENERAL NOTES:

1. CCTV Cameras are used for emergency response and process monitoring. These cameras have no security function.
2. All Cameras except Y14 are roof mounted. exact camera heights will be determined later.
3. Camera Y14 shall be mounted on a 28' pole. Pole and weatherhead are by others
4. CCTV camera 7 & 8 for view of ops outside CLA.

LEGEND:

 ZOOM

 PAN/TILT/ZOOM

Ynn CAMERA NUMBER

## GENERAL REVISIONS

**OPERATIONS SECURITY  
SENSITIVE**

"DISTRIBUTION AUTHORIZED TO U.S. GOVERNMENT AGENCIES AND  
THEIR CONTRACTORS ONLY, CONTAINS TECHNICAL OR OPERATIONAL  
INFORMATION. THIS DETERMINATION WAS MADE ON 20 NOVEMBER 2005

OTHER REQUESTS FOR THIS DOCUMENT WILL BE REFERRED TO: LES, PUEBLO  
CHEMICAL DEPOT, CO, 81006-9330, BLDG 54, (719) 549-4258

DESTRUCTION NOTICE: IF THIS MATERIAL CAN NOT BE RETURNED TO PCO  
LES IT MUST BE DESTROYED BY A METHOD THAT WILL PREVENT  
DISCLOSURE OF CONTENTS OR RECONSTRUCTION OF THIS DOCUMENT."

C	4/18/06	GENERAL REVS. AND DRCHECKS COMMENTS ADDRESSED 1106738 1106740, 1106711 1106743, 1106746 1107872, 1107878 REISSUED FOR FINAL DESIGN	GLCEPMEPM			
B	1/31/06	GENERAL REVISIONS AND SECURITY STAMP REISSUED FOR INTERNAL USE	GLCEPMEPM			
A	1/26/06	INCORPORATED GENERAL REVISION FOR REDESIGN AND CHANGED DOCUMENTNUMBER (SUPERSEDES 24852-3PS-000-J022) REISSUED FOR TEAM REVIEW	GLCEPMEPM			
REV	DATE	REASON FOR REVISION	BY	CWID	ESS	PROG APP

BECHTEL PUEBLO TEAM

PUEBLO CHEMICAL AGENT-DESTRUCTION  
PILOT PLANT PROJECT (PCAPP)

CONTRACT NO.	DAAA09-02-D-0025
--------------	------------------

## CCTV SYSTEM OUTDOOR CAMERAS LOCATION PLAN

SCALE	DWG. NO. 24852-RD-JD-J07-J0022	REV C
-------	-----------------------------------	----------

SDATES	STIMES	FILE ABBREVS
--------	--------	--------------